

Project Location
Ground Floor
50 Lonsdale Street
Melbourne

1_Urban Workshop's public meeting area with the fusion of various messmate timber units forming tables, benches and seats.
2_A ground floor lift lobby with timber panelling.
3_Upper-storey lift lobby continues the Urban Workshop design theme throughout all floors of the tenancy.
4_An imposing sight: Urban Workshop's thoroughfare linking public areas, retail shops and workplaces above.

Client
Multiplex
Constructions

Design
WBNH:
John Wardle Architects
HASSELL
NH Architecture

Schiavello Vic Fitout
Richard Halasa
Matthew De Carolis
Andrew Howard
Darryn Lafranchi

Schiavello Prima Architectural
Robert Pegoraro
Ronald Klaaysen

Area
5700 m²

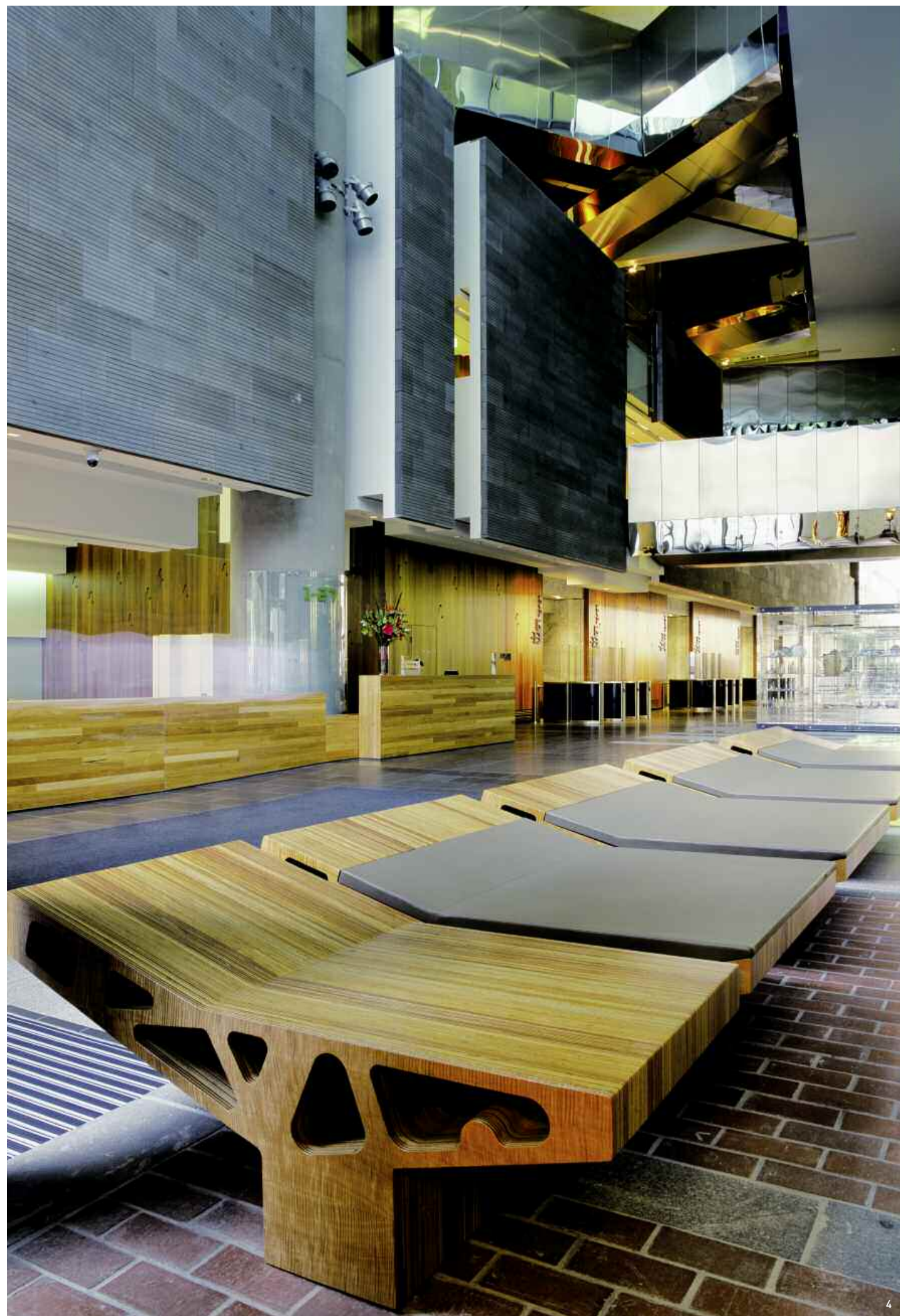

URBAN WORKSHOP
50 LONSDALE ST – GROUND FLOOR
FITOUT + JOINERY

Urban Workshop is the striking new feature piece adorning the patchwork of Melbourne.

BEYOND THE METROPOLIS

An outstanding demonstration of a commercial high-rise lobby, Urban Workshop's ground floor is breath-taking in its scope, scale and visual appeal, with the finer details also sure to impress. The design team (WBNH: a joint venture between John Wardle Architects, HASSELL and NH Architecture) has celebrated many and varied accolades at the Royal Australian Institute of Architecture 2006 Victorian awards. Urban Workshop's awards include commercial architecture, interior architecture, urban design and a shared prize for making a significant contribution to the Melbourne CBD. Skillfully linking several buildings with arcades and internal laneways, Urban Workshop is the fusion of tenancies resulting in a miniature urbanism. With its adulation of the metropolis' community, all are welcome to partake in their daily rituals of eating and socialising within the shared, open plaza space. It is a complete departure from anything conservative or expected of an office tower, with the distinctions between the street and the interior blurred. Contrasting the warmth of timber finishes with cool, crisp modernity, there is connection between the old and the new; of particular importance considering the heritage of existing buildings used in the tenancy. Glass display cases house remnants salvaged in the excavation of the site as a connection with the site's history.

The bustling heart of the city is drawn into the space and emulated throughout with the city skyline-like structures, repeated diversely on all planes (referenced on a smaller scale in the AustralianSuper offices, levels 32 and 33, see page 50). Exposure of above floors' activities and overhead walkways assist in the illusion of a 'city within a city'. Adding this prestigious project to their list of accomplishments, Schiavello's Victorian Fitout team was selected for their expertise in first-class interior commercial environments. Undertaking the meticulous joinery of prominent public eating areas (Schiavello's Prima Architectural), along with the 'city-skyline' structural features, timber messmate security and main reception counters, Schiavello's capabilities produced a top-quality result. Connection of all floors was important in the design, with each level's lift lobby repeating the design theme of the ground floor. Schiavello also undertook the joinery and fitout of these areas on all 33 levels with their stylised timber finishes. Setting the scene for a tower of tenancies including private companies and 27 floors of Victorian Government departments (Dept Human Services and Sustainability Victoria), an inspired introduction to these progressive work environments is made. Linger at the brink before entering another corporate space, Urban Workshop is the ideal transition between the energetic city of Melbourne and the professional realm within.