



System 30 panels



technical





System 30 panels

System 30 panels are simple to understand, plan and install.

Complete rigidity is achieved with an economy of parts and materials.

A breakthrough design that combines elegant simplicity, with strength and quality engineering.

Index

panels **02-03**

junctions and connectors **04-07**

cable reticulation **08-09**

worksurfaces **10**

accessories **11**

images **12**

specification of system 30 panel system **13**



Panels

base panels | suspended panels

Key Features

High flexibility with fast assembly, reconfiguration and relocation requiring a single allen key.
Panels are 30 mm thick with [load bearing] top transom rail and off-module panel capability.
Minimal componentry required for panel junctions available in 90°, 120° and linear. Optional cable reticulation and outlet modules.

Choice of standard panel construction, optional pinable or acoustic sound absorbing panel cores.
Seamless compatibility with comprehensive ranges of desking, storage, tables and accessory options.
Extensive selection of panel types, colours and finishes.
All components are reusable.

BASE PANELS

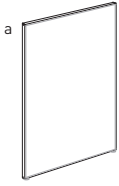

code S30.S1

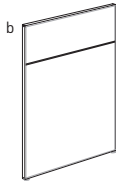

code S30.S2



code S30.G1-1-CG

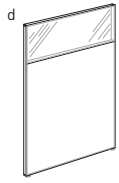

code S30.SG-1-CG

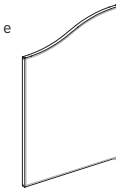

code S30.S1-W

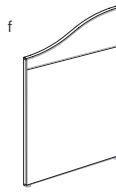

code S30.S2-W

When System 30 panels are required to support transom hung or function wall hung shelves 'block type' panel core construction **must be** specified

- a_Solid panel
- b_Two piece solid panel with mid transom
- c_Centre full glazed panel
- d_Two piece centre partial glazed panel with mid transom
- e_Solid panel with wave top
- f_Two piece solid panel with mid transom and wave top

BASE PANELS

panel heights (mm)	panel widths (mm)									
	450	600	750	800	900	1200	1500	1800	2100	2400
900	•	•	•	•	•	•	•	•	•	•
1050	•	•	•	•	•	•	•	•	•	•
1200	•	•	•	•	•	•	•	•	•	•
1350	•	•	•	•	•	•	•	•	•	•
1500	•	•	•	•	•	•	•	•	•	•
1800	•	•	•	•	•	•	•	•	•	•
2100	•	•	•	•	•	•	•	•	•	•
2400	•	•	•	•	•	•	•	•	•	•

*Special sizes available on request

SUSPENDED PANELS

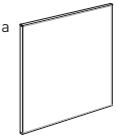

code S30-SU.S1

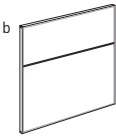

code S30-SU.S2

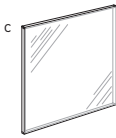

code S30-SU.G1-1-CG

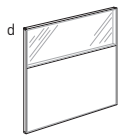

code S30-SU.SG-1-CG

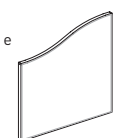

code S30-SU.S1-W

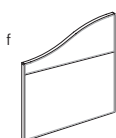

code S30-SU.S2-W

- a_Solid panel
- b_Two piece solid panel with mid transom
- c_Centre full glazed panel
- d_Two piece centre partial glazed panel with mid transom
- e_Solid panel with wave top
- f_Two piece solid panel with mid transom and wave top

SUSPENDED PANELS

panel heights (mm)	panel widths (mm)							
	450	600	750	800	900	1200	1500	1800
900	•	•	•	•	•	•	•	•
1050	•	•	•	•	•	•	•	•
1200	•	•	•	•	•	•	•	•
1350	•	•	•	•	•	•	•	•
1500	•	•	•	•	•	•	•	•

* Special sizes available on request

* Panel height dimensions show the actual heights of the panels
They do not include suspension distance from floor

Panels

glazing option | wall starter bracket | finishes

SUSPENDED PANEL ATTACHING BRACKETS

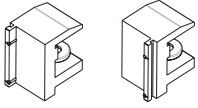

code S30/45-CLM-L.H.
S30/45-CLM-R.H.

GLAZING OPTIONS

Centre glazing
Flush glazing - single sided
Flush glazing - double sided

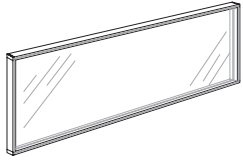

centre glazing CG

Glass is offered in both clear and translucent
Other finishes available on request

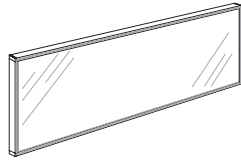

flush glazing 1-FG or 2-FG

Glass is offered in both clear and translucent
Can be single or double sided

WALL STARTER BRACKETS

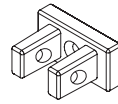

code WS1B-30

connectors required
1-wall starter brackets

FINISHES

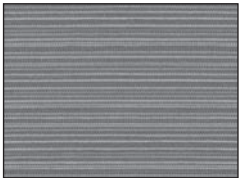

fabric

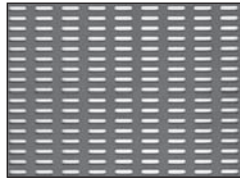

perforated metal
CR perforation

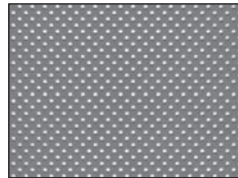

perforated metal
MW perforation

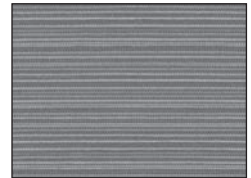

pinable fabric screen



powdercoated MDF



laminate



veneer

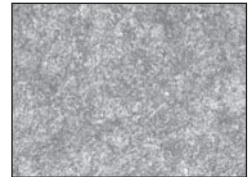

echo panel

Panel faces can be specified in a variety of finishes as illustrated
Panel trims are finished in hard wearing powdercoat with colour as selected
Materials and colours are subject to availability

Junction Connectors

straight junction | 90° two way open junction | 90° two way closed junction | 90° three way open junction
 | common height panels

Each common height junction has an individual product code no. as shown.
 Connectors are specified as one set for each junction.

By specifying the code no's and quantities of the **junctions required**,
 the appropriate quantity and type of connectors will be supplied.

STRAIGHT JUNCTION

COMMON HEIGHT PANELS

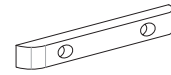
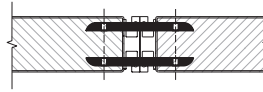
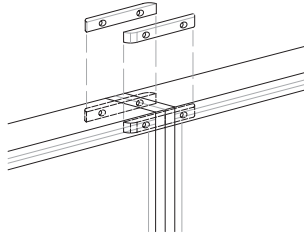
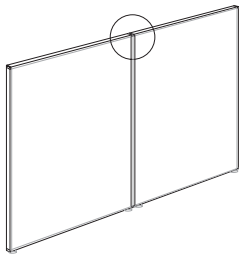

set code S30.J180.1W.S (base panel set)

Junction connector set comprises
 2-type B-671 011 connectors

set code S30-SU.J180.1W.S (suspended panel set)

Junction connector set comprises
 4-type B-671 011 connectors

90° TWO WAY OPEN JUNCTION

COMMON HEIGHT PANELS

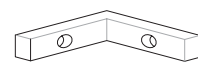
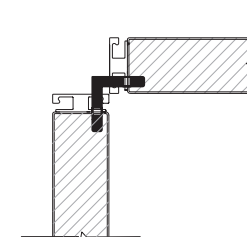
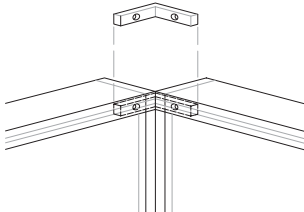
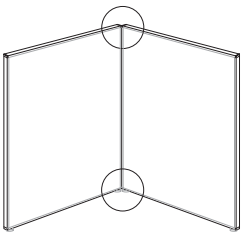

set code S30.J90.2W.O

Junction connector set comprises
 2-type B-671 005 connectors

90° TWO WAY CLOSED JUNCTION

COMMON HEIGHT PANELS

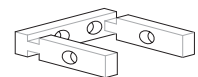
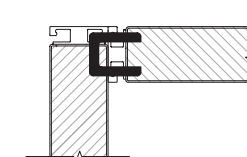
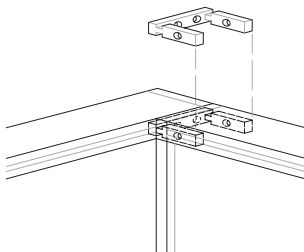
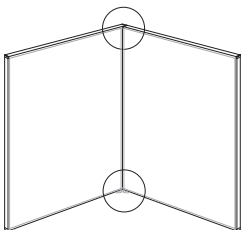

set code S30.J90.2W.C

Junction connector set comprises
 2-type B-671 016 connectors

90° THREE WAY OPEN JUNCTION

COMMON HEIGHT PANELS

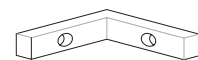
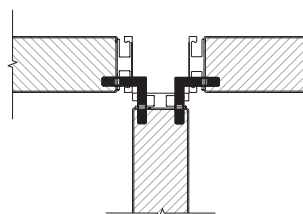
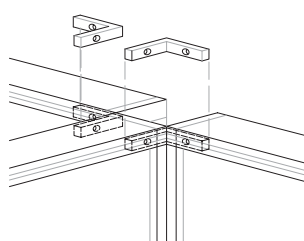
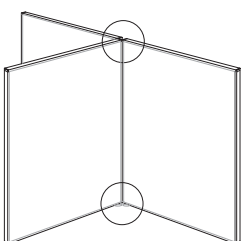

set code S30.J90.3W.O

Junction connector set comprises
 4-type B-671 005 connectors

Junction Connectors

90° three way closed junction | 90° off module junction | 90° four way junction | 90° four way umbilical junction
 | common height panels

90° THREE WAY CLOSED JUNCTION

COMMON HEIGHT PANELS

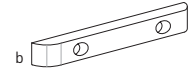
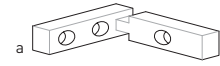
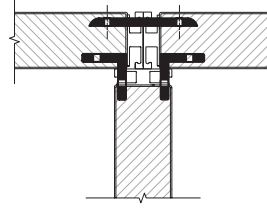
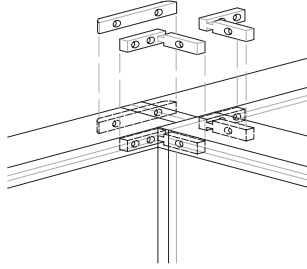
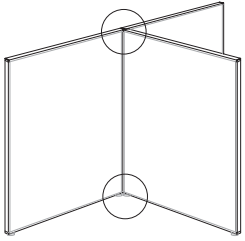

set code S30.J90.3W.C

Junction connector set comprises
 a_4-type B-671 003 connectors and
 b_2-type B671 011 connectors

90° OFF MODULE JUNCTION

COMMON HEIGHT PANELS

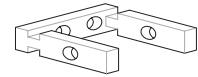
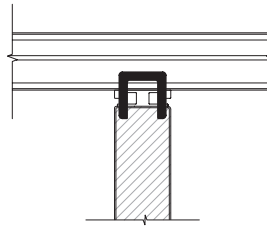
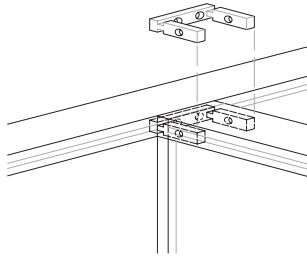
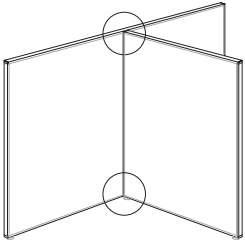

set code S30.J90.3W.OM

Junction connector set comprises
 2-type B-671 016 connectors

90° FOUR WAY JUNCTION

COMMON HEIGHT PANELS

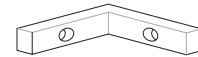
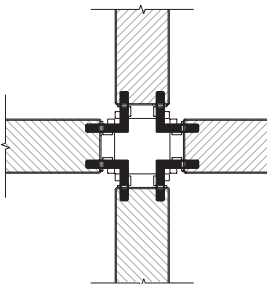
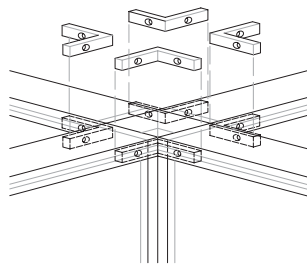
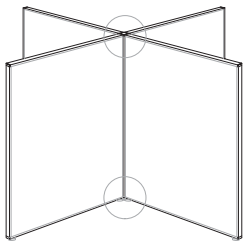

set code S30.J90.4W.C

Junction connector set comprises
 8-type B-671 005 connectors

90° FOUR WAY JUNCTION

Panels set for umbilical entry
 [56 mm wide access opening]

COMMON HEIGHT PANELS

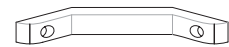
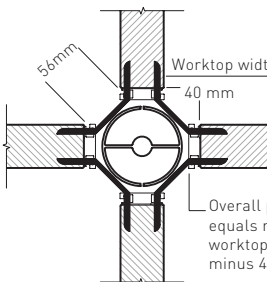
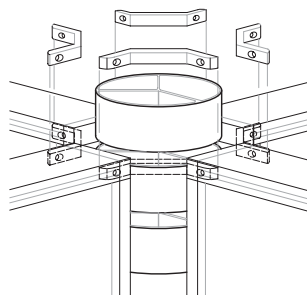
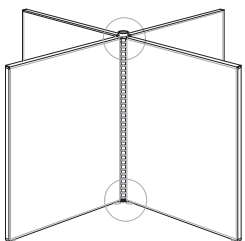

set code S30.J90.4W.U (4 way junction)

Junction connector set comprises
 8-type B-671 015 connectors

set code S30.J90.3W.U (3 way junction)

Set comprises
 4-type B-671 015 connectors

Junction Connectors

120° three way junction | 120° tech column three way junction | common height panels

Each common height junction has an individual product code no. as shown. Connectors are specified as one set for each junction.

By specifying the code no's and quantities of the **junctions required**, the appropriate quantity and type of connectors will be supplied.

120° THREE WAY CLOSED JUNCTION

COMMON HEIGHT PANELS

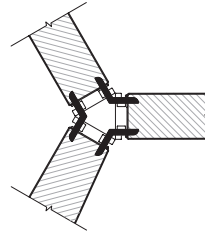
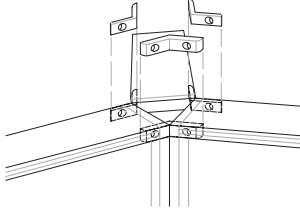
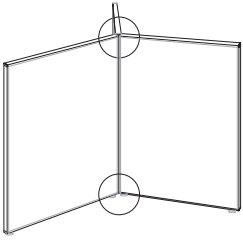

set code S30.J120.3W.C

Junction connector set comprises 6-type B-671 004 connectors

120° THREE WAY JUNCTION

Panels set for services access (44 mm wide access opening)

COMMON HEIGHT PANELS

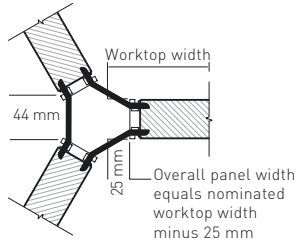
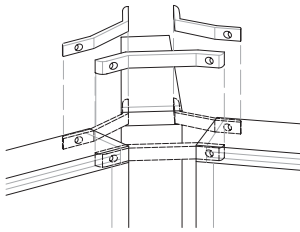
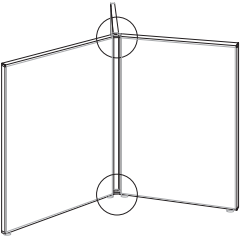

set code S30.J120.3W.0

Junction connector set comprises 6-type B-671 009 connectors

120° THREE WAY JUNCTION

Panels set for umbilical entry (113 mm wide access opening)

COMMON HEIGHT PANELS

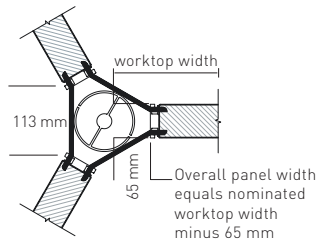
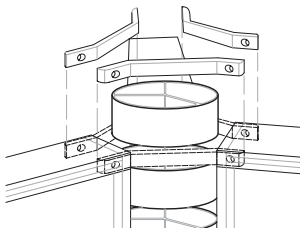
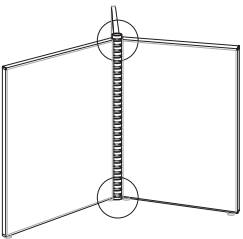

set code S30.J120.3W.U

Junction connector set comprises 6-type B-671 014 connectors

120° TECH COLUMN THREE WAY JUNCTION

Panels connect to tech column

COMMON HEIGHT PANELS

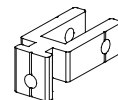
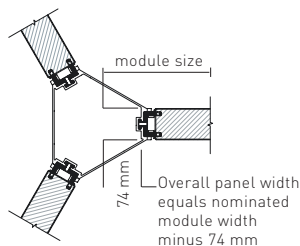
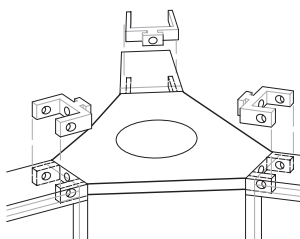
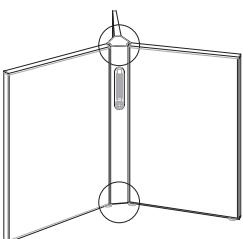

set code S30.J120.3W.TC

Junction connector set comprises 6-type 671-017 connectors

Junction Connectors

180° straight junction | 90° two way open junction | 90° two way closed junction | 90° off module junction
 | transition height junctions

Junction connectors for transition height junctions are specified **per each not 'per set'**. Each of the examples shown below indicate the connector product codes and the quantity required of each to achieve the junction.

180° STRAIGHT JUNCTION

TRANSITION HEIGHT PANELS

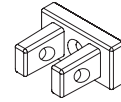
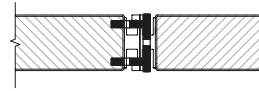
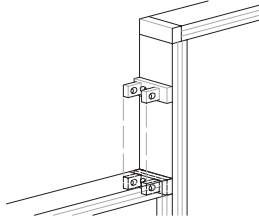
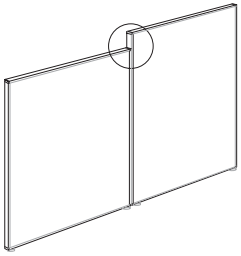

code WS1B-30

connectors required

1-wall starter brackets

90° TWO WAY OPEN JUNCTION

TRANSITION HEIGHT PANELS

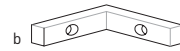
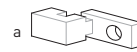
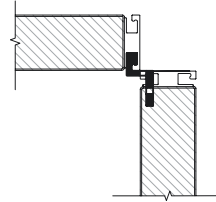
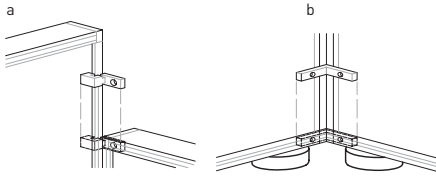
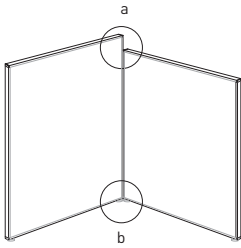

connectors required

a_1- type B-671 013 connector

b_1- type B-671 005 connector

90° TWO WAY CLOSED JUNCTION

TRANSITION HEIGHT PANELS

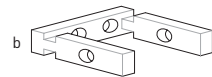
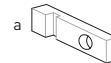
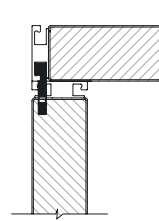
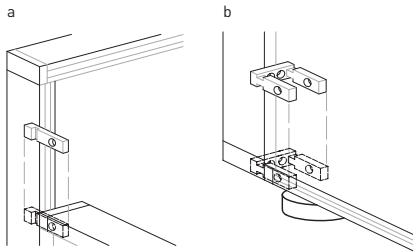
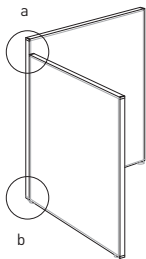

connectors required

a_1- type B-671 001 connector

b_1- type B-671 016 connector

90° OFF MODULE JUNCTION

COMMON HEIGHT PANELS

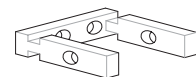
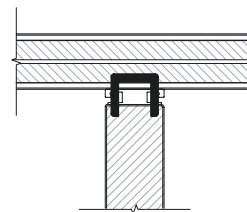
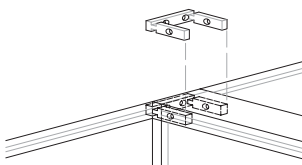
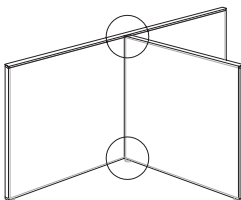

connectors required

2- type B-671 016 connectors

Cable Reticulation

cable routing | power blades | umbilical | 120° tech column | cylinder power pole

Cable routing

System 30 offers a number of cable routing options. They can be combined to satisfy specific requirements while always providing easy access and efficient cable management throughout entire layouts.

Cables can be routed to panels from ceilings, walls or floors by utilising umbilicals, power blades or tech columns.

POWER BLADES (system 45 panel)

Cable entry from ceiling or floor
Exit points to suit requirements

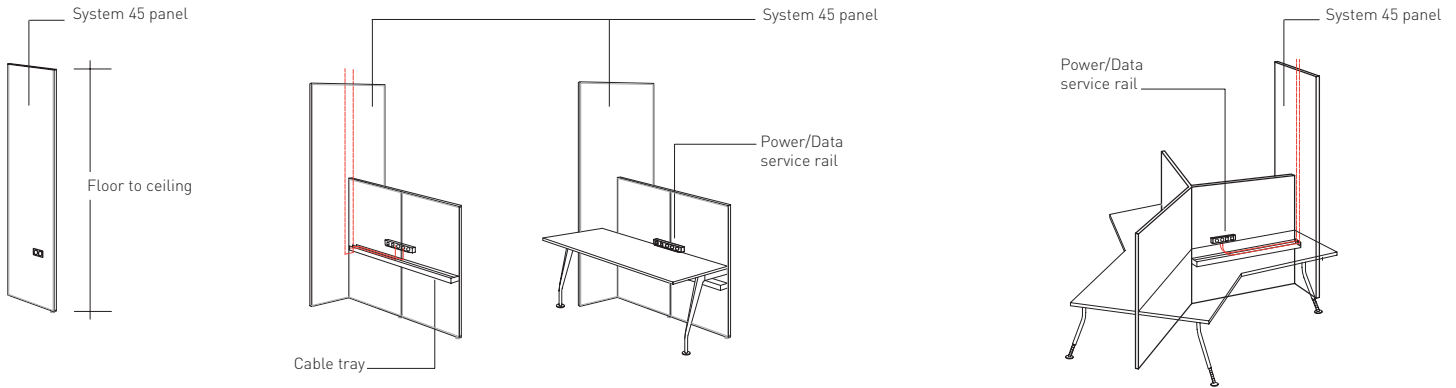

UMBILICALS

Panels set for umbilical entry
(56 mm wide access opening)

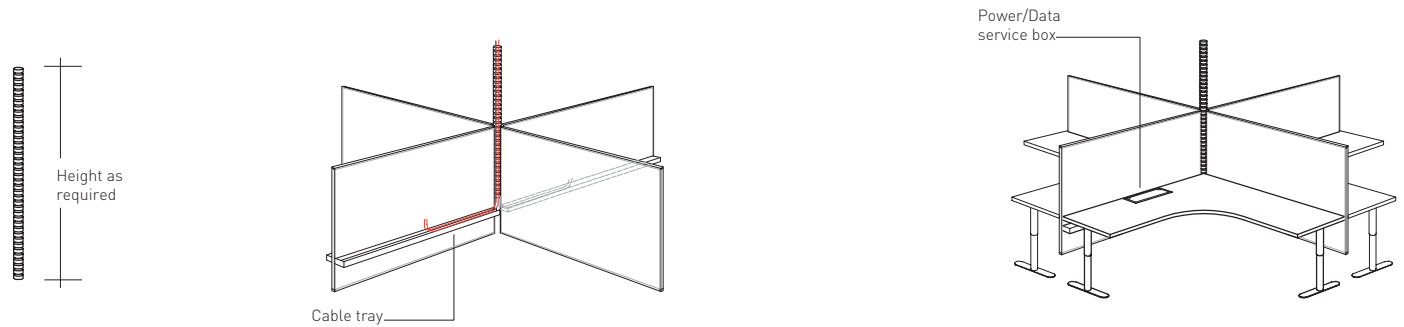

120° TECH COLUMN

Direct cable access from floor
Ceiling access through top of tech column
via umbilical or 80 mm dia. cylinder power pole

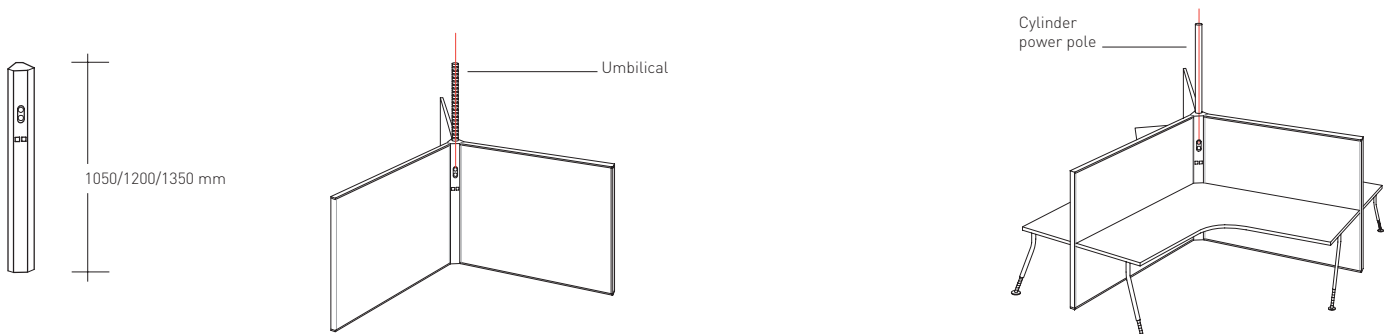

Cable Reticulation

interpower soft wiring system | cable trays and baskets

Interpower softwiring system

Schiavello interpower electrical softwiring system delivers power and lighting to office workstations. The system is easily connected, disconnected or relocated without the need to isolate power and with minimal inconvenience.

All connections within the interpower system are protected by a positive lock mechanism to prevent accidental power disconnection. All components are factory tested and easy to install. All interpower softwiring components are reusable.

STANDARD SERVICE RAIL



code SR/2P/4D
code SR/3P/4D
code SR/4P/4D

Mounts to rear of desktop

POWER MODULES

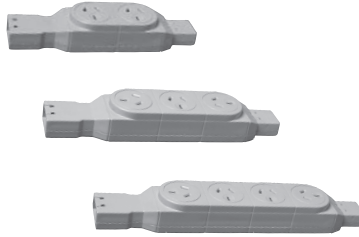

code PM2H
code PM2HTVL
code PM4VL

DATA MODULES

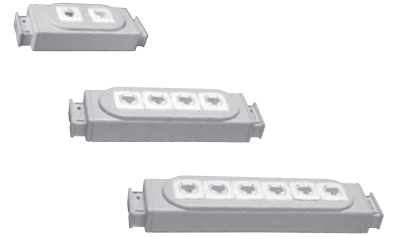

code NGDM/2
code NGDM/4
code NGDM/6

INTERPOWER SOFTWIRING SYSTEM

Refer to Schiavello Interpower brochure SCH/W05-C for complete product information and technical specifications



code SS
Starter sockets



code JB-S
Junction box



code EX-S00 (add length
i.e. 600m lead =
EX-S00600)
Extension leads

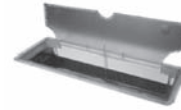

code IDBO.1
Power/Data service box
Inserts into desktops



code S45CAP
Cable access port
Optional panel fitting where
required to provide cable access
through closed junctions

Cable trays and brackets

Optional cable trays and brackets attach to either system 45 panels or underside of worksurfaces.

These simple lay-in and very flexible designs ensure cables can be neatly accommodated without intruding on to the worksurface or floor.

CABLE TRAYS AND BRACKETS

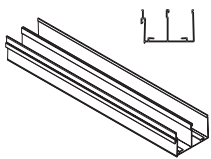

code EL/SERDCT-SQ
height 50 mm
depth 100 mm
width to order
Elitone metal cable tray



code S45/SERDCT/L
Cable tray
support bracket L.H.
Attaches to vertical mullion
of system 45 panels



code S45/SERDCT/R
Cable tray
support bracket R.H.
Attaches to vertical mullion
of system 45 panels

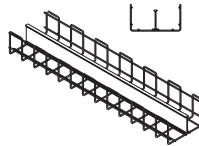

code 2CW
height 80 mm (inc.brackets)
depth 160 mm
length 660/860/1060 mm
Cable baskets
Supplied with two brackets attaches
to underside of worksurfaces

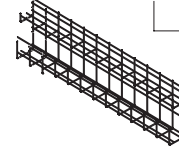

code STTWB
height 230 mm
depth 95 mm
length 900/1200 mm
Cable baskets
Supplied with two brackets attaches
to underside of worksurfaces

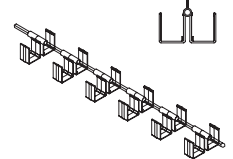

code QWCM-ASSY
height 65 mm
depth 120 mm
length to order
QED cable tray
Attaches to underside
of worksurfaces

Worksurfaces

typical workstation clusters for system 30 | worksurface support brackets | worksurface support legs

Worksurfaces

Worksurfaces can be specified either 25 mm or 33 mm thick. Available finishes include selected laminates, timber veneers and powdercoated MDF in a range of colours.

There is a wide selection of shapes and sizes to ensure the right solution for task specific requirements. Edge finishes and shapes also offer many choices with custom shapes available on request.

TYPICAL WORKSTATION CLUSTERS FOR SYSTEM 45

Cluster examples using various shaped worksurfaces

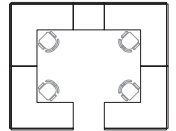
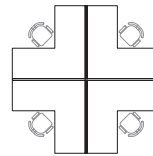
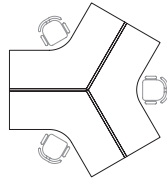
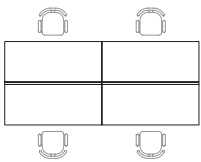

WORKSURFACE SUPPORT BRACKETS

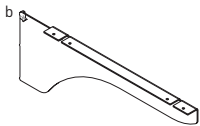
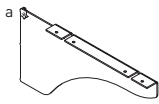

a_code S45.D400LH-C
b_code S45.D600LH-C
length a_358 mm/b_495 mm
 Curved desk support brackets
 Left hand

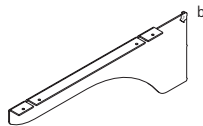
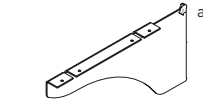

a_code S45.D400RH-C
b_code S45.D600RH-C
length a_358 mm/b_495 mm
 Curved desk support brackets
 Right hand

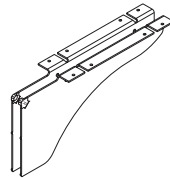

a_code S45.D400D-C
b_code S45.D600D-C
length a_358 mm/b_495 mm
 Curved double desk support brackets

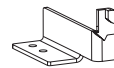

code S45.FTS-LH
 Front top support bracket
 Left hand

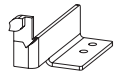

code S45.FTS-RH
 Front top support bracket
 Right hand

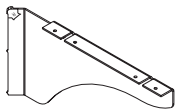

code S45.D400LH-45-C
length 350 mm
 Curved corner desk support brackets
 Left hand

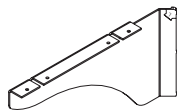

code S45.D400RH-45-C
length 350 mm
 Curved corner desk support brackets
 Right hand

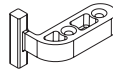

code S45/PNL-LCK-GUIDE
 Panel locking guide. (Unhanded)
 (Holds panels against adjustable height worksurface)



code DJ-50
size 50 mm x 50 mm
 Underdesk joining plates

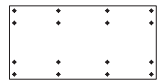

code DJ-300/400/500/600
depth 150 mm
wide 300/400/500/600 mm
 Underdesk joining plate

WORKSURFACE SUPPORT LEGS

Fixed height

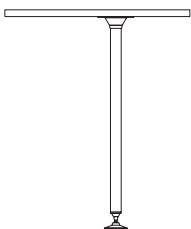

height Leg 695 mm plus worksurface
dia. 28 mm dia. QED
code QLIF-NB-STRT

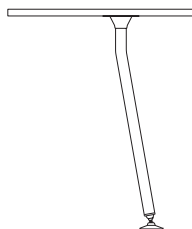

height Leg 695 mm plus worksurface
dia. 28 mm dia. QED
code QLIF-NB-10°

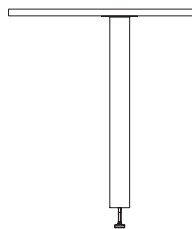

height Leg 687 mm plus worksurface
dia. 70 mm dia. leg
code U10 leg

WORKSURFACE SUPPORT LEGS

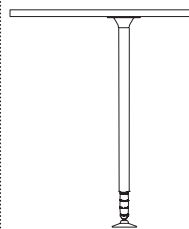

height Height adjustable leg 610 mm to 735 mm plus worksurface
code QED3-STRT

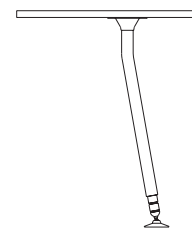

height Height adjustable leg 610 mm to 735 mm plus worksurface
code QED3-10°

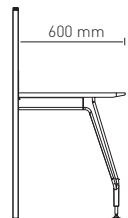

height Height adjustable leg 625 mm to 705 mm plus worksurfaces
code Marina leg

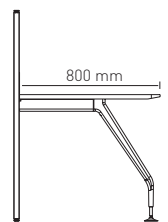

Accessories

function walls | accessories

Function walls

Mount to transom rails of system 30 panels via integral mounting detail. Additional brackets not required.

FUNCTION WALLS

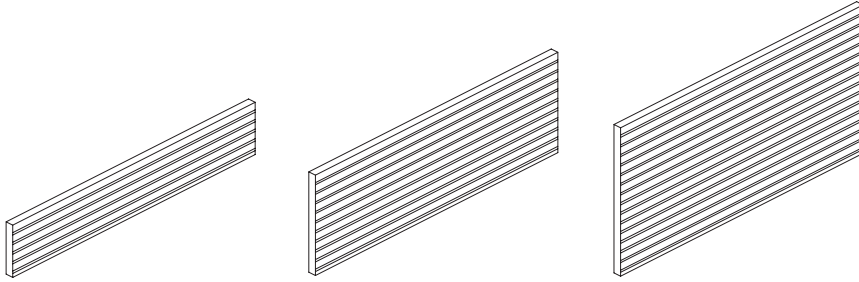

height 150 mm
type FWT-150

height 300 mm
type FWT-300

height 450 mm
type FWT-450

ACCESSORIES - FOR TRANSOM RAIL AND FUNCTION WALL MOUNT

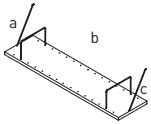

side_a 300 mm
side_b 600|750|900|1050|1200
side_c 250|300|350|410 mm
type ULT-SHLF-25

Ultimet shelf

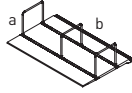

side_a 300 mm
side_b 600|750|900|1050|1200
type ULT/SHLF-LINE-0600-DIV

Slimline shelf

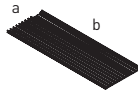

side_a 200 mm
side_b 150|260|390|520
type ULT CD SHELF

CD holder 2-3-4

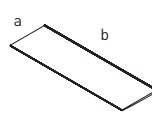

side_a 225 mm
side_b 600|750|900|1050|1200
type ULT/SL/SHELF-600

Slimline mini shelf

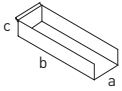

side_a 50 mm
side_b 158 mm
side_c 26 mm
type ULT-PTRAY/SM

Ultimet pencil tray - small

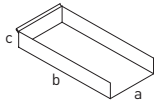

side_a 122 mm
side_b 319 mm
side_c 26 mm
type ULT-PTRAY/LG

Ultimet pencil tray - large

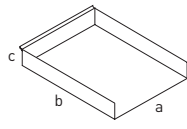

side_a 245 mm
side_b 319 mm
side_c 26 mm
type ULT-STRAY

Stationery tray (portrait)

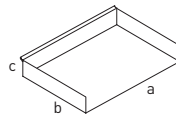

side_a 313 mm
side_b 251 mm
side_c 26 mm
type ULT-STRAY-A4

Ultimet paper tray - A4 landscape

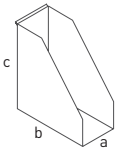

side_a 115 mm
side_b 265 mm
side_c 272 mm
type ULT-PHBOOK

Ultimet phone book holder

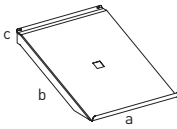

side_a 245 mm
side_b 325 mm
side_c 39 mm
type ULT-PHTRAY

Ultimet phone tray

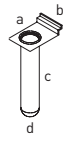

side_a 67 mm
side_b 40 mm
side_c 125 mm
side_d 25 mm
type ULT/VASE

Vase



side_a 40 mm
side_b 40 [overall height]
type TH/CH

Transom hung coat hook

Natural anodised finish

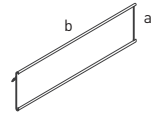

side_a 49 mm
side_b 170 mm
type TH/NAMEPLATE 170

Tansom hung name plate



Specification of System 30 Panel System

general | panels | connectors | cable reticulation | aluminium finish | warranty

General

System 30 is a fully refined office panel system manufactured by Schiavello Australia. The system is stackable, easily demounted, relocated, extended or reduced in size with all components being reusable.

Panels

The panels have a thickness of 30 mm with single panel widths of up to 2400 mm.

They have a load bearing top transom rail and are designed to be either floor mounted or suspended from desks as required and as specified later. The panels are rigid, with the strength to support hampers, shelves and worktops.

They also have provision to accept accessories from both a horizontal and vertical position. The panels provide both integrated and transom mounted whiteboards and function walls including a full range of attachable accessory items.

Panel faces offer a choice of finishes including fabric, perforated metal, powdercoated MDF, laminate, timber veneer, fabric covered pinboard as well as single and double glazing.

Acoustic panels are also offered that have an acoustic sound absorption rate of not less than 60 NRC

Connectors

The connecting system achieves the following junctions and connections:

- (a) 90°, 120°, 180°
 - (b) 2 way, 3 way and 4 way junctions with either open access corners or closed corners.
 - (c) Off module junctions ie: return panels of common or differing heights are able to achieve a 90° connection to a spine panel at any point along its length.
-

Cable Reticulation

The system includes integrated components that provide efficient means of routing services cabling to the panels from the ceiling, walls or floor. such as power blades, umbilicals or power poles.

The system also includes optional clip-on segregated cable trays with a selection of services outlet modules and soft wiring connections. The softwiring electrical system is Schiavello Interpower certified to AS/NZS 3131.

Aluminium Finish

All aluminium is powdercoated to Australian Standard AS-NZ3570. Colour as specified.

Warranty

The manufacturer warrants the system for a period of not less than 5 years against faulty materials and workmanship and guarantees the supply of parts and service of all standard components for a period of not less than 10 years from date of installation.



