

Buddle Findlay

"The result is an office space that is dynamic, flexible, and above all a pleasant place to work," John Walton, Partner + Project Manager, Buddle Findlay.

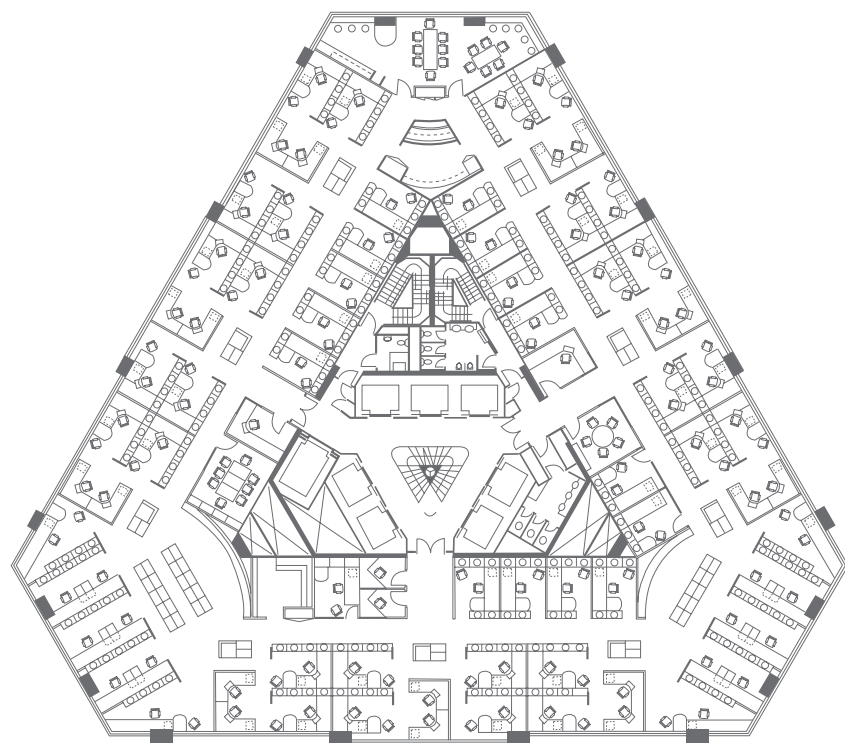

Buddle Findlay, one of New Zealand's leading commercial law firms, had a clear goal in approaching its Auckland office relocation into the PricewaterhouseCoopers Tower – an efficient workspace.

To this end, occupying three levels in the new prestigious PricewaterhouseCoopers Tower on Auckland's waterfront allowed Buddle Findlay to create a work environment specifically for its requirements. The firm was able to assess what its clients and staff expected of the reception and entertainment areas, meeting rooms, support services, and shared work areas for its legal teams.

Moving away from the conservative, closed-door, environment traditionally associated with law firms, Buddle Findlay embraced a more open, collaborative workspace concept that would encourage teamwork and facilitate the flow of ideas.

The challenge was to create an efficient, flexible work environment without compromising the size of individual workpoints and addressing the requirement of degrees of privacy.

The workspace developed by Geyer was a 'kit of parts' solution to work settings specifically to suit the firm's requirements. Flexibility was paramount. The workplace system, based on Schiavello's Ultimet work environment, was prototyped and tested prior to construction.

The design of the work floors centres on the concept of a library, with the key element of the furniture system being the 'knowledge spine' - a series of bookcases with integrated whiteboards and reference shelves. These provide high levels of storage and visual and acoustic separation between work areas.

A number of formal and informal meeting spaces, some featuring Liberty chairs, satisfy the need for staff and partners to gather and share the collegiality fundamental to the practice of law.

The result is a workplace that can be reconfigured to suit the changing composition of teams and market conditions. "Our clients' businesses are constantly evolving – and it is appropriate that we too can adapt and modify the way we work to deliver a high standard of legal service," said John Walton of Buddle Findlay.

project details ... PROJECT LOCATION ... Level 17-19, PricewaterhouseCoopers Tower, Auckland, New Zealand
CLIENT ... Buddle Findlay – John Walton **DESIGN ...** Geyer - Peter Geyer, Bronwyn Pratt, Kelly Hall, Claudette Leeming, Patricia Bondin, Prue Pascoe; Jasmx - Tim Hoosen, Kirsty Mitchell **KADA COMMERCIAL FURNITURE ...** John Gilbert, Dave White **SCHIAVELLO INTERNATIONAL ...** Aaron Scott **AREA ...** 4000 m² **PRODUCTS ...** Ultimet screen system + workstations, steel privacy screens, custom made spine walls, Liberty seating.

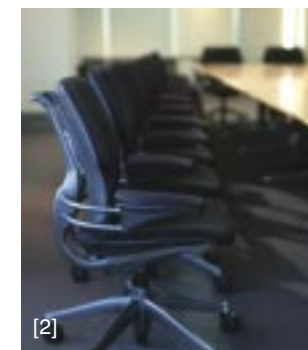

Above [1] ... Typical work setting featuring Ultimet veneer spines providing power + data reticulation with a knowledge spine - a series of book cases with integrated white boards + reference shelves. [2]... Client floor boardroom featuring Liberty seating - a total of 120 chairs were supplied in the board + meeting rooms. [3] ... Viewshafts inset into strategically placed knowledge spine units offer workpoints on the internal core, a link with the external panoramic views and natural light filtration. [4] ... Custom made privacy screens help delineate space in an open environment.